

Safety Precautions:

The Ready-Fit storm drain filter should be maintained by trained individuals who are familiar with local traffic safety regulations and disposal procedures. If working in the street, proper safety equipment should be worn, including but not limited to a hardhat, vest, gloves and eye protection, and all local traffic safety rules & regulations should be followed.

Inspecting the Ready-Fit:

To maintain the efficiency of the Ready-Fit stormwater filter, regular maintenance is necessary. Fabco Industries advises inspecting the unit every six months, following the steps outlined below. It's important to note that inspection and cleaning should only take place after 24 hours of no rainfall. It's also recommended to periodically examine the surrounding areas for pollutants, such as oil or paint dumping, minor spills, and leaks from dumpsters, and take the appropriate measures to have the source removed. To begin the inspection, remove the storm grate to gain full access to the Ready-Fit filter unit. Be cautious, as grates can be quite heavy, and a lifting mechanism is recommended. Use a battery-powered flashlight or droplight to conduct a thorough visual inspection, checking for heavy sediment, debris loading, and trash. Certain signs indicate that cleaning or filter replacement is necessary. These include standing water in the Ready-Fit sack, inability to see the filter unit due to sediment, trash, or debris, and damage to the sack, such as abrasions, tears, or punctures. If any of these signs are present, make a note of your observations and comments on a maintenance log sheet. It may also be useful to take digital photographs or sketches to maintain accurate historical records.

Cleaning Frequency:

The Ready-Fit device needs regular cleaning, but determining the appropriate cleaning intervals is not an exact science. Typically, smaller units and installation sites with more sediment or vegetation require more frequent maintenance. Fabco Industries suggests cleaning the unit(s) at least twice annually by manually removing debris, sand, and silt or using a vacuum-assisted device. In situations where there is a greater amount of sediment or vegetation at the installation site, it may be advisable to increase the cleaning frequency of the unit(s) beyond the recommended bi-annual cleaning schedule suggested.

Disposal:

Proper handling and disposal of all captured liquid, oils, sediment, debris, trash, and other accumulations from the Ready-Fit unit must comply with local, state, and federal regulations. As part of a well-planned and scheduled maintenance regime, disposal considerations should be taken into account. Generally, solid waste disposal can be arranged with a local landfill, while liquid waste can be disposed of at either a wastewater treatment plant or a municipal vacuum truck decant facility.

Step 1:

To access the Ready-Fit unit, carefully remove the storm grate and place it in a designated safe area. Assess whether removing the unit is required for cleaning. If removal is necessary, lifting straps are provided as an integral part of the replaceable StormSack. While lifting the Ready-Fit out of the storm drain, it is essential to ensure that at least two workers lift evenly to prevent injury or damage to the filter assembly.

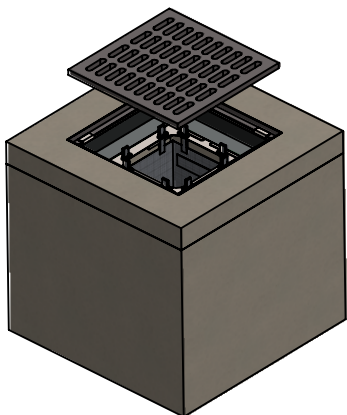

Step 2:

For deep cleaning, rinse the filter unit with a high pressure hose to dislodge and remove sediment and debris that may be clogging the geotextile fabric and restricting flow. If a high pressure hose is not available, a stiff scrub-brush can be used instead. If necessary, replace the StormSack by simply removing the strap clips to release.

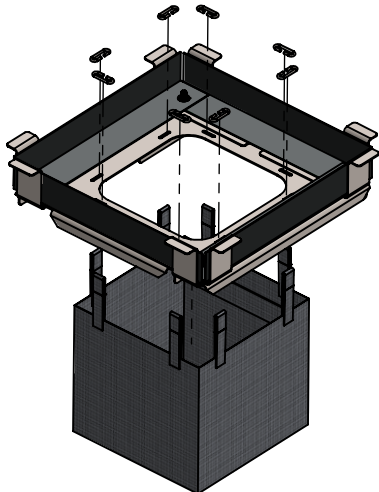

Step 3:

After completing the maintenance work on the Ready-Fit, ensure that the unit is reinstalled correctly if it was removed, and confirm that all flanges are securely resting on the grate support ledges to guarantee proper functioning. If required, record any pertinent observations or comments about the maintenance on a maintenance log sheet.

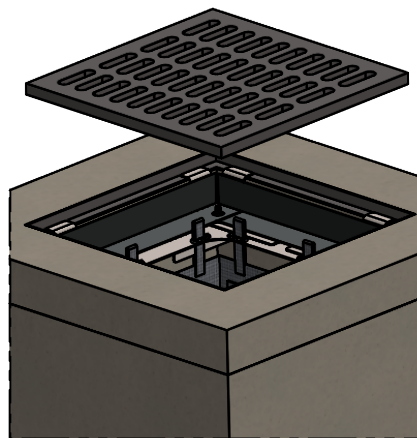

Step 4:

As a final step, and before reinstalling the storm grate, be sure to thoroughly clean the work area making sure not to leave behind any tools or objects that may cause a traffic hazard or a pedestrian tripping hazard. Reinstall the storm grate making sure it is seated properly on the frame.

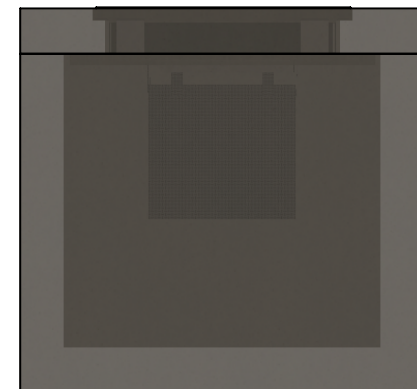

TITLE:	MAINTENANCE GUIDE	REV:	A
READY-FIT STORMSACK			