



## Selecting, Removing and Installing the StormBasin Cartridges

The Fabco filter cartridges used in the StormBasin product are designed primarily to capture: floating materials, sediments and suspended solids and emulsified products such as hydrocarbon compounds, dissolved heavy metals, nutrients (P&N) and pathogens (bacteria). Before ordering your cartridges make sure you select the correct type. Each cartridge type can be identified by a colored “Ring” located at the top of the cartridge.

### Selecting the right cartridge(s)

Part Number	Effectiveness	Ring color code
9718-1	<b>Standard Cartridge</b> Good All-purpose cartridge for common surface runoff that may contain a little bit of everything.	Red
9718-2	<b>Pathogens Cartridge</b> 2x's more pathogen treatment Vs. Std Cartridge. Use near sensitive water ways to keep beaches and shell fishing areas open.	Yellow
9718-3	<b>HV Hydrocarbon Cartridge</b> 25% more hydrocarbon filter media Vs Std cartridge. Excellent for vehicle or maintenance related applications.	Blue
9718-4	<b>HV Metals Cartridge</b> Uses unique FABLITE filter media for HV metals. Suggested for industrial usage where persistent HV metals have been identified in surface runoff	Grey
9718-5	<b>Standard short Cartridge</b> Reduced height version of std Cart.	Mint
9718-6	<b>Nutrients Cartridge</b> Uses proprietary FABPHOS media for nutrients. Highly effective on the critical dissolved Ortho-Phosphates. Helps reduce algae blooms keeping the water clean and healthy.	Green

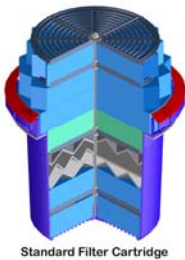

Standard Filter Cartridge

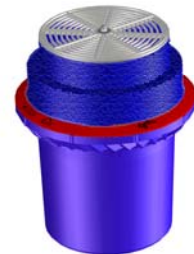



Fabco suggests changing, the standard cartridge a minimum of once per year. Fabco's special short cartridge should be replaced twice per year.

### Removing the Filter Cartridge(s)

With all debris removed from the StormBasin the filter cartridge(s) will be exposed at the bottom. To remove the cartridge(s) reach down into the basin and firmly grasp the plastic outer rim of the cartridge body just below the foam. Twist the cartridge body Counter-Clock-wise about ¼ turn until it stops. Lift the cartridge straight up to remove.



### Installing new Filter Cartridge(s)

The StormBasin filter cartridge(s) install through a hole in the bottom of the collection basin. The hole has four (4) slots that accept 4 tabs molded into the underside of the cartridge body.



Insert the StormBasin cartridge down through the hole in the base of the unit. The colored ring on the cartridge should be facing upwards. Push the cartridge all the way through the hole until it rests on the bottom. Slowly turn the cartridge in a Clock-wise direction until the Tabs align with the slots and the cartridge body drops about ¼' further down.



Once the Tabs fall through the slots, continue turning firmly in a Clock-wise direction until the Tabs contact the STOPS. The Cartridge is now installed.

